

NEW

Thick-wall penetration sleeve for heat insulated wall

FLANGED WALL SLEEVE

<Long-Type> FPF-60

Cutmarks embossed at 1cm (0.4in.) intervals on sleeve surface facilitate cutting to correct length.

When cutting the end, reversing and jointing the sleeve, integral 5° slope ensures correct pitch for drain line.*
(Refer to "Installation to drainage slope" in Specification)



Permits thick walls up to 250mm (10in.) thickness (200mm (8in.) with drainage slope).

Specification

Dimensions

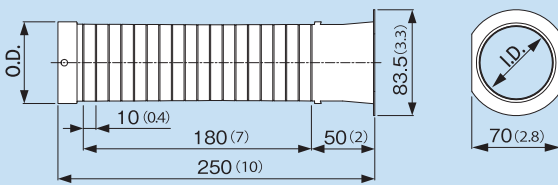

Unit : mm (in.)
Material : PE+PP

* Installation to drainage slope (under 5°)

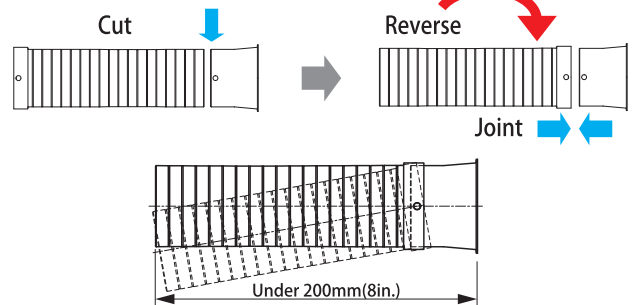

Code No.	Item No.	I.D.	O.D.	Core drill diameter	Price	Pcs/Pkg
03980	FPF-60	57mm(2.3in.)	64.5mm(2.5in.)	∅ 65mm(2.6in.)	Open	100

Contact

INABA DENKI SANGYO CO., LTD.

OVERSEAS SALES DEPARTMENT
INABA DENKO PRODUCTS DIVISION

4-11-14, ITACHIBORI, NISHI-KU, OSAKA, JAPAN 550-0012
Tel: +81-6-4391-1920 Fax: +81-6-4391-1935

<http://www.INABA-DENKO.com/>